

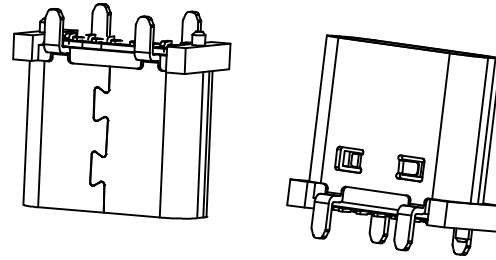

|     |             |            |          |
|-----|-------------|------------|----------|
| REV | DESCRIPTION | DATE       | APPROVED |
| A   | 新版发行        | 2024.08.03 | HHM      |

SPECIFICATION:

- ELECTRICAL:
  - CURRENT RATING:5A;
  - CONTACT RESISTANCE:40mΩ Max;
  - DIELECTRIC WITHSTANDING VOLTAGE:100V AC;
  - INSULATION RESISTANCE:100 MΩ MIN;
- MECHANICAL;
  - MATING FORCE:5~20N;
  - UNMATING FORCE:8~20N;
  - DURABILITY:10000 CYCLES;6~20N AFTER DURABILITY TEST;
- MATERIAL:
  - HOUSING&MOLDING:PA9T BLACK UL94V-0;
  - TERMINAL:C7025 T=0.15mm;
  - SHELL:SUS304 T=0.30mm;
  - MID PLATE:SUS304 T=0.20mm;
- PLATING SPECIFICATION:
  - TERMINAL:CONTACT POINT GOLD PLATED 3u" Min  
PIN WELDING AREA GOLD PLATED 1u" Min.
  - NI 40U" Min. UNDER PLATED OVER ALL.
  - SHELL:PLATED Ni 50u" Min(Salt spray 48H)
- ELECTROPLATED PRODUCTS NEED TO UNDERGO TIN ADHESION TESTING: THE TIN ADHESION AREA SHOULD REACH OVER 95%.
- SMT REFLOW SOLDERING (PEAK VALUE 260 ° C ± 5 ° C) SHALL BE FREE OF BLISTERING, GLUE MELTING AND POOR COLOR CHANGE (DEFORMATION WITHIN TOLERANCE)
- OPERATING TEMPERATURE: -40° C~+85° C



3D VIEW

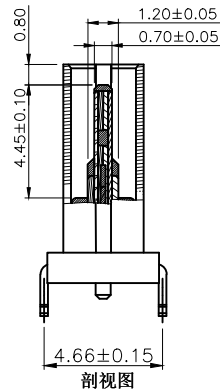
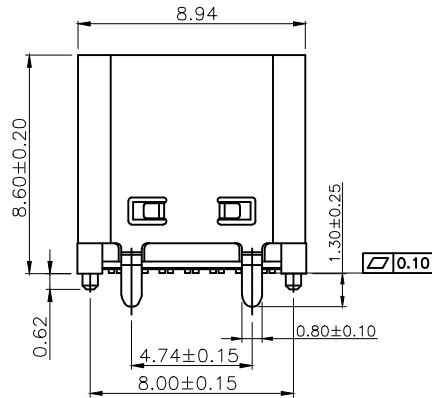
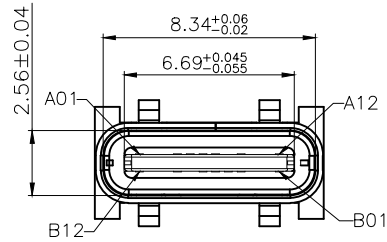

剖视图

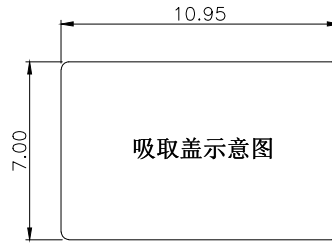

吸取盖示意图

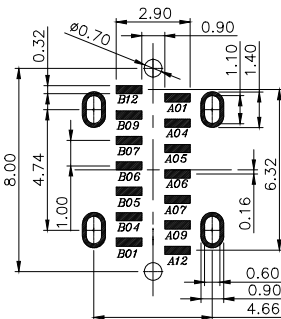
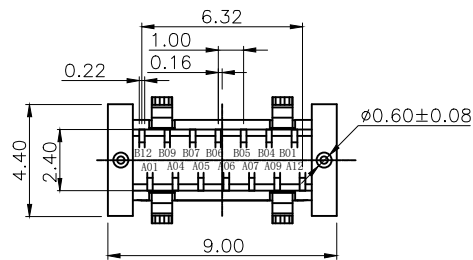
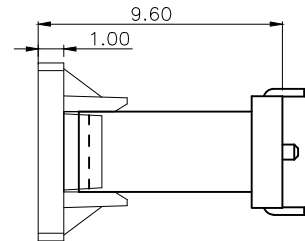

RECOMMENDED P. C. B. LAYOUT (T:1.00mm)  
TOLERANCE UNSPECIFIED ±0.05mm

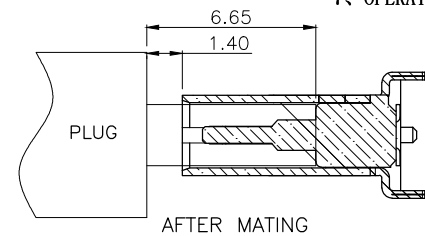

AFTER MATING

|     |             |     |             |
|-----|-------------|-----|-------------|
| A1  | GND         | B12 | GND         |
| A4  | VBUS        | B9  | VBUS        |
| A5  | CC1         | B7  | Dn2         |
| A6  | D+          | B6  | Dp2         |
| A7  | D-          | B5  | CC2         |
| A9  | VBUS        | B4  | VBUS        |
| A12 | GND         | B1  | GND         |
| PIN | SIGNAL NAME | PIN | SIGNAL NAME |

| CUSTOMER DRAWING  |               |                 |
|-------------------|---------------|-----------------|
| UNITS<br>mm       | SCALE<br>1:1  | SHEET<br>1 OF 2 |
| PROJECTION:<br>   | DRAW:<br>DAP  |                 |
| GENERAL TOLERANCE | CHECK:<br>HWT |                 |
| .000 ±0.15        | APPD:<br>HHM  |                 |
| .00 ±0.20         |               |                 |
| .0 ±0.25          |               |                 |
| .0 ±2°            |               |                 |
| .00 ±1°           |               |                 |

|  |           |          |            |
|--|-----------|----------|------------|
| 铭创科技（东莞）有限公司<br>Mingchuang Technology (Dongguan) Co., Ltd. |           |          |            |
| TITLE<br>TYPE C母座14PIN 立式四脚插版SMT L=8.6                     |           |          |            |
| MAT'L  | SEE TABLE | FINISH   | SEE TABLE  |
| DWG. NO.   | A031419A  | PART NO. | SIZE<br>A4 |



|     |             |            |          |
|-----|-------------|------------|----------|
| REV | DESCRIPTION | DATE       | APPROVED |
| A   | 新版发行        | 2024.08.03 | HHM      |

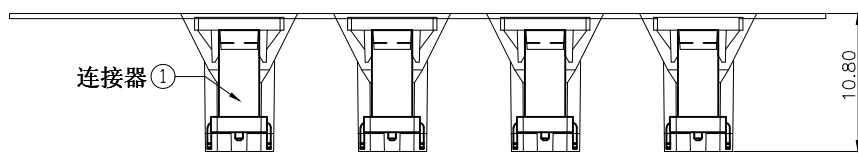
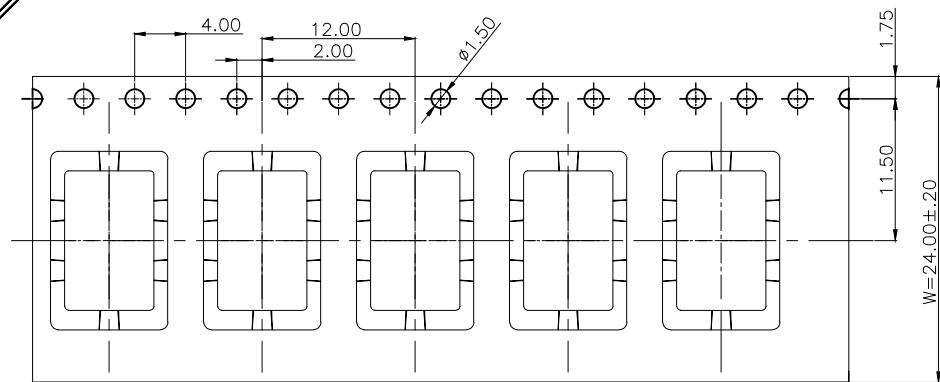

产品入载带示意图

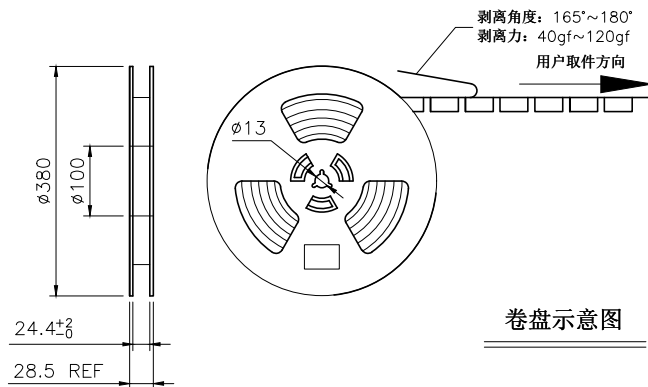

卷盘示意图

包装示意图

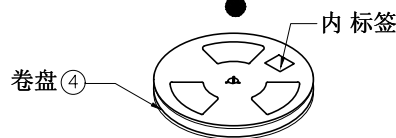
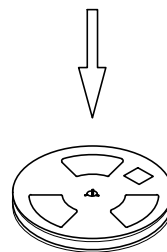

卷盘贴标签示意图

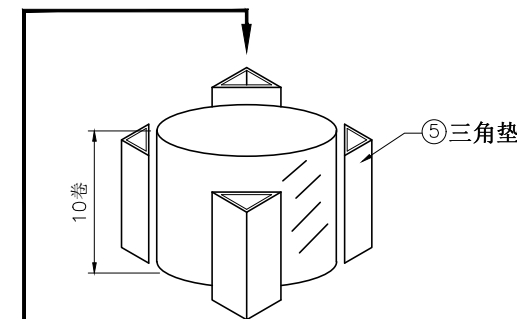

10盘产品叠层示意图

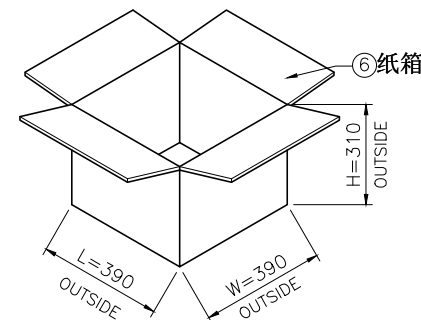

技术要求:

- 载带首尾各留出10PCS空格不装产品;
- 每穴放置1PCS产品, 每卷装700PCS产品, 放置方式如图所示;
- 将包装好的产品;每盘必需贴上内标签;将贴好内标签的产品每10盘堆叠.
- 在纸箱四角垫上4个三角垫, 然后把装好产品的卷盘放入纸箱中, 最后用胶带封箱; (如客户有要求, 请按客户要求包装出货)
- 上带与载带的剥离力: 40gf~120gf, 跳动量在30gf内; (剥离角度: 165°~180°, 剥离速度: 250~300mm/min)
- 产品符合RoHS环保标准要求.

|    |      |           |                            |          |
|----|------|-----------|----------------------------|----------|
| 06 | 纸箱   | B-05-0012 | 390mm*390mm*310mm          | 1 PCS    |
| 05 | 三角垫  | /         | 300mm*260mm*7mm            | 4 PCS    |
| 04 | 卷盘   | /         | D=380mm, d=100mm, H=28.5mm | 10 PCS   |
| 03 | 上带   | /         | W=20.7mm, T=0.05mm         | 8600 mm  |
| 02 | 载带   | B-03-0011 | W=24mm, T=0.50mm, P=12.0mm | 8600 mm  |
| 01 | 连接器  | A031419A  | 16PIN, DIP                 | 7000 PCS |
| 序号 | 物料名称 | 物料编号      | 规格                         | 描述       |

|   |              |                 |  |                      |                                 |
|---|--------------|-----------------|--|----------------------|---------------------------------|
| CUSTOMER DRAWING  |              |                 | 铭创科技(东莞)有限公司<br>Mingchuang Technology (Dongguan) Co., Ltd. |                      |                                 |
| UNITS<br>mm   | SCALE<br>1:1 | SHEET<br>2 OF 2 | TITLE<br>TYPE C母座14PIN 立式四脚插版SMT L=8.6                     |                      |                                 |
| PROJECTION:<br>   |              | DRAW:<br>DAP    |  | MAT'L<br>SEE TABLE   |                                 |
| GENERAL TOLERANCE<br>.000 ±0.15<br>.00 ±0.20<br>.0 ±0.25<br>.0 ±2°<br>.00 ±1° |              | CHECK:<br>HWT   |  | FINISH<br>SEE TABLE  |                                 |
|   |              | APPD:<br>HHM    |  | DWG. NO.<br>A031419A | PART NO.<br>_____<br>SIZE<br>A4 |